

# Grand Master Ballroom

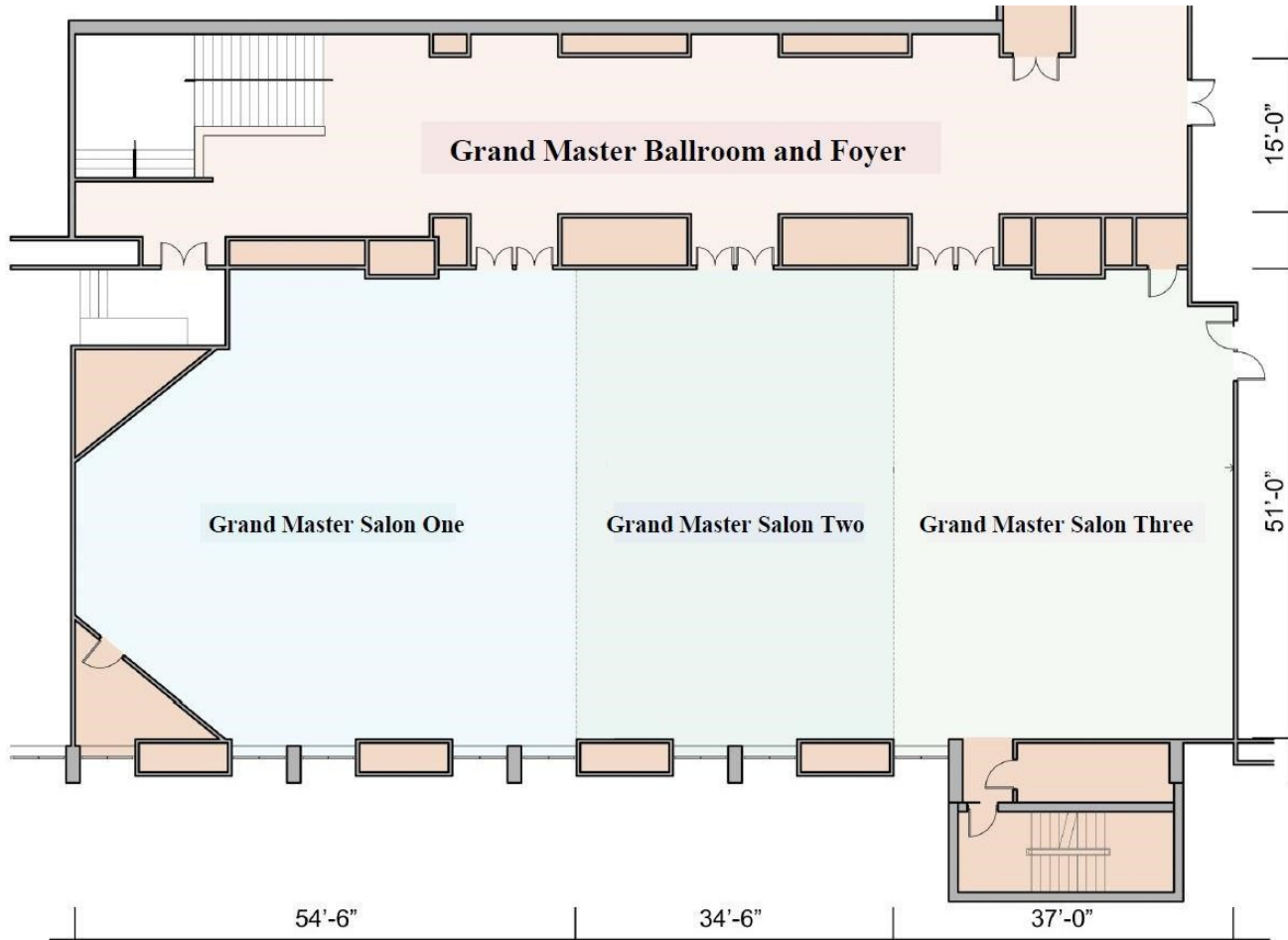

54'-6"

34'-6"

37'-0"

15'-0"

51'-0"

Grand Master Salon One

Grand Master Salon Two

Grand Master Salon Three

Grand Master Ballroom and Foyer

## REVERE MEETING ROOM DIMENSIONS & CAPACITIES

ROOM NAME	SQUARE FEET	DIMENSIONS	CEILING HEIGHT	CLSRM	CONF	ROUNDS	CRESC	U-SHAPE	THEATER	RECEPTION	8x8 BOOTHS
GRAND MASTER BALLROOM	6,342	124 X 50	9	360	160	400	240	150	450	600	35
GRAND MASTER 1	2,814	55 X 50	9	150	70	170	100	70	200	150	14
GRAND MASTER 2	1,623	31 X 50	9	100	60	90	50	30	80	70	8
GRAND MASTER 3	1,838	36 X 50	9	110	60	100	60	50	90	100	7